

# ASSEMBLY INSTRUCTIONS

KFR9000 – Adapter, New Holland FR Harvester to John Deere Header

2015 Version

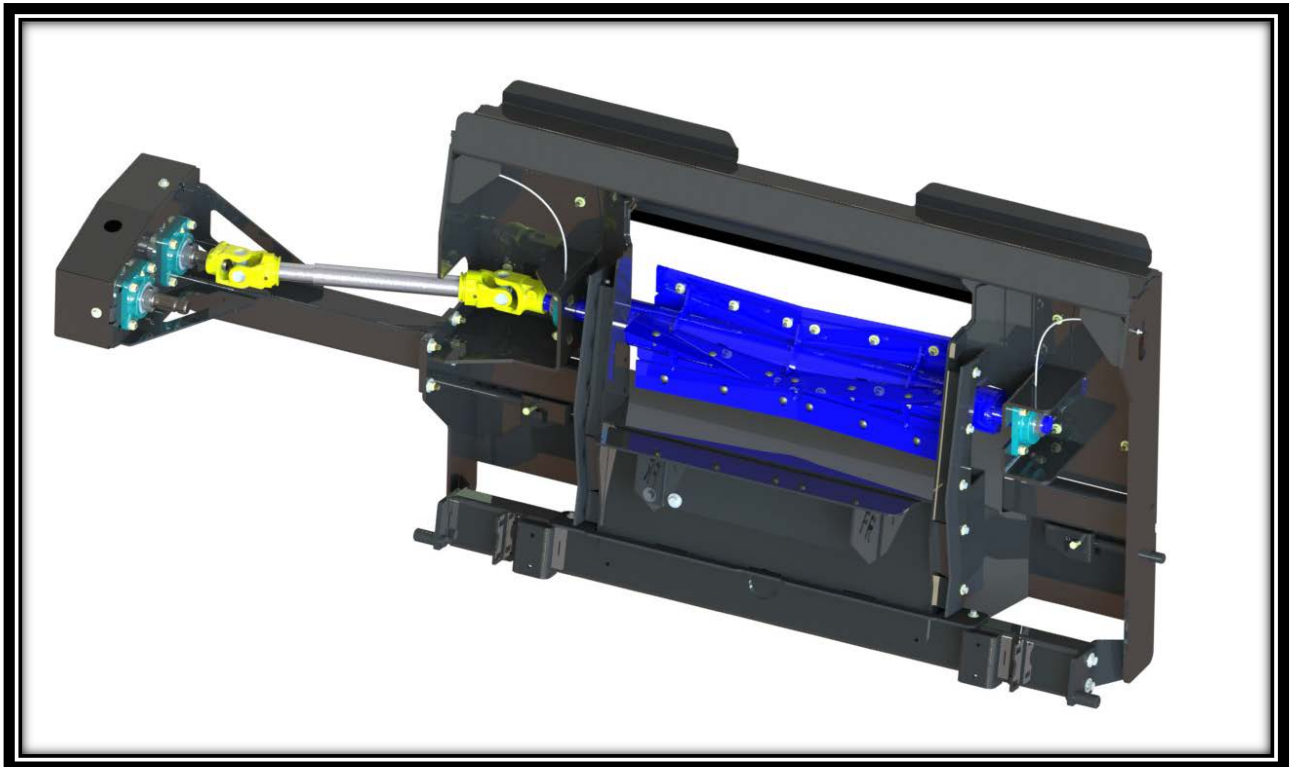

**KOOIMA**  
COMPANY



1-800-522-8874

Thank you for your purchase of this Kooima Company earlage adapter.

You should have received an assembled base unit (KNHBASE) and a kit containing parts to fit up to a New Holland FR-series forage harvester (KFR9000). These instructions will help you assemble the kit onto the base unit.

Please follow the enclosed instructions carefully to prepare your adapter for a successful and safe harvest.

When fastening bolts, please torque each bolt according to the following table, unless otherwise specified:

<b>Recommended Bolt Torque [ft-lb]</b>		
<b>Bolt Size</b>	<b>Grade 5</b>	<b>Grade 8</b>
3/8"	23	33
1/2"	57	80

1. Assemble the four teeth onto the flap wheel as shown. Gloves are recommended, as the teeth are very sharp.

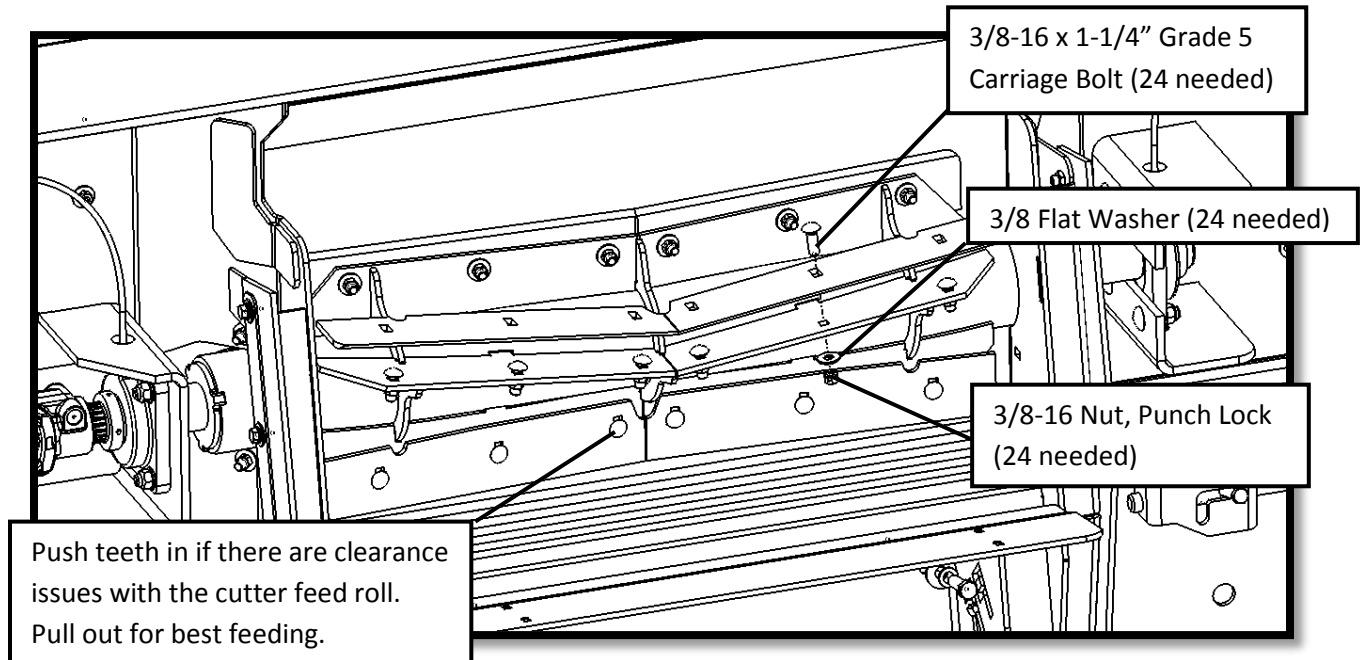

2. Install the lower connect pins (left and right) as shown.

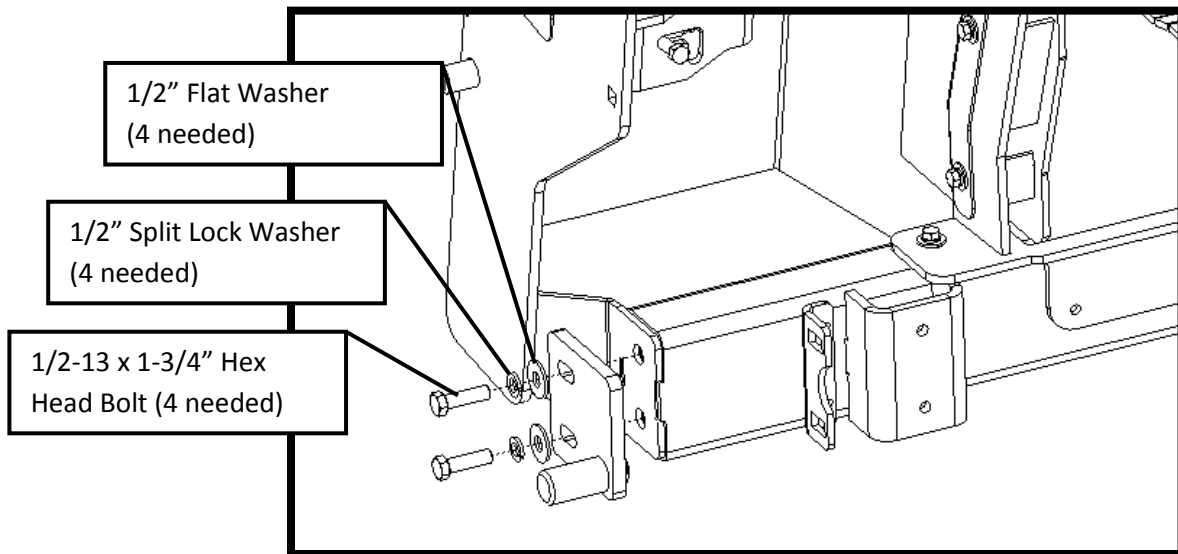

3. Install bottom, left, and right sealing flaps as shown.

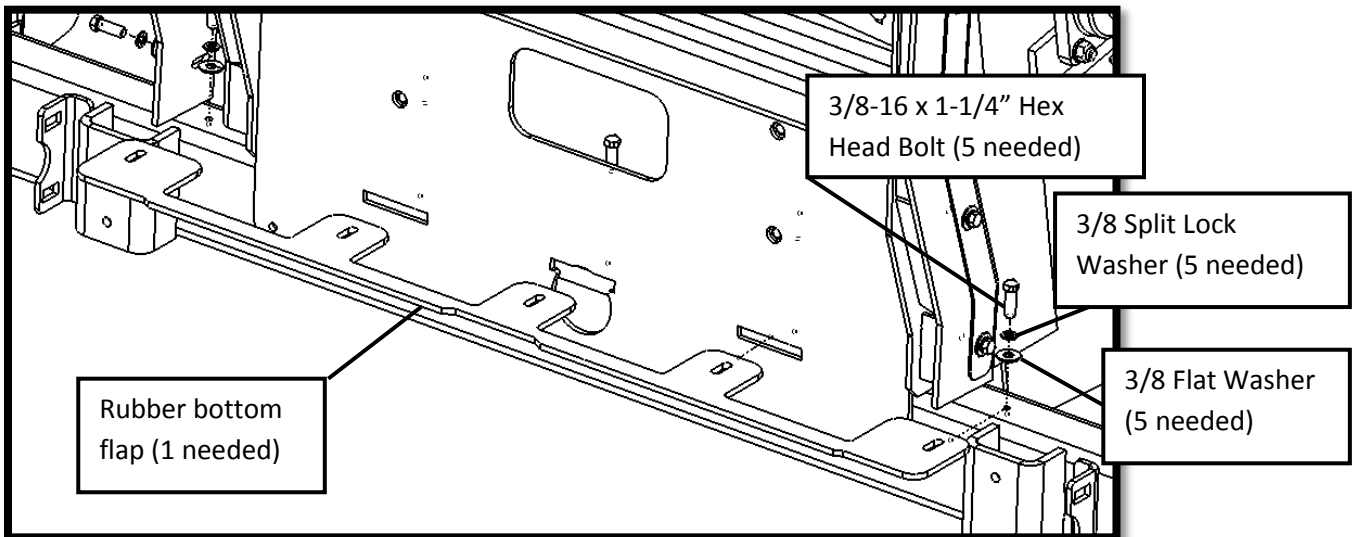
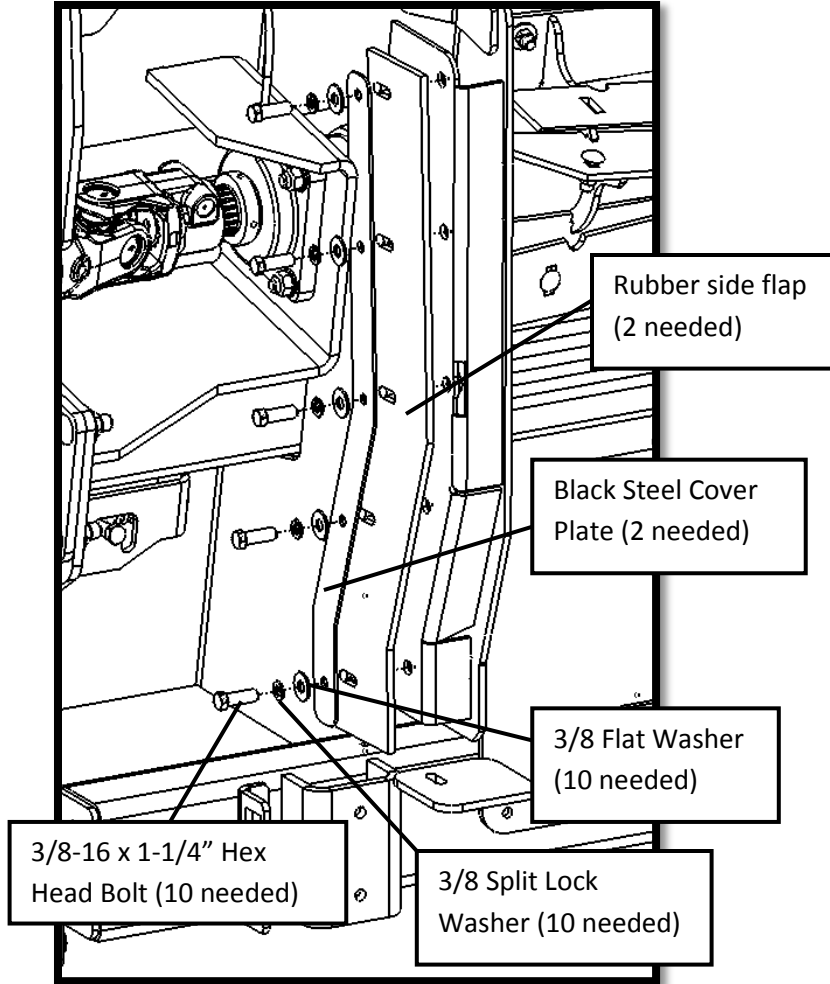

4. Install the floor extension as shown. Use LOC-TITE threadlocker or similar product to ensure the floor extension does not come loose during operation.

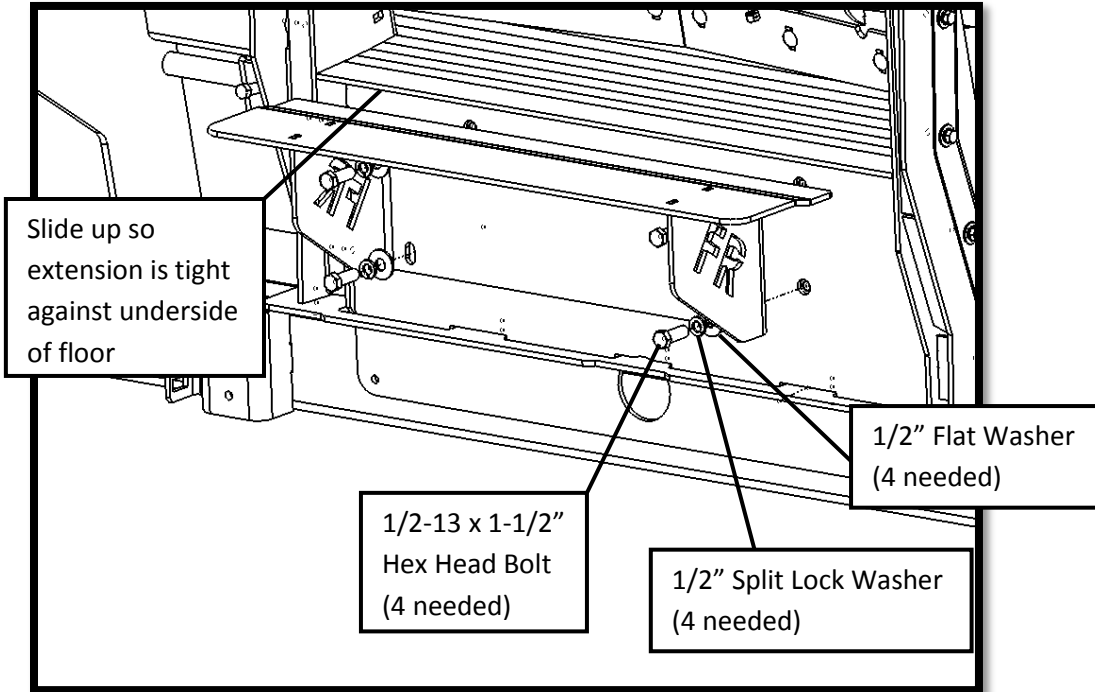

5. Install front shield as shown.

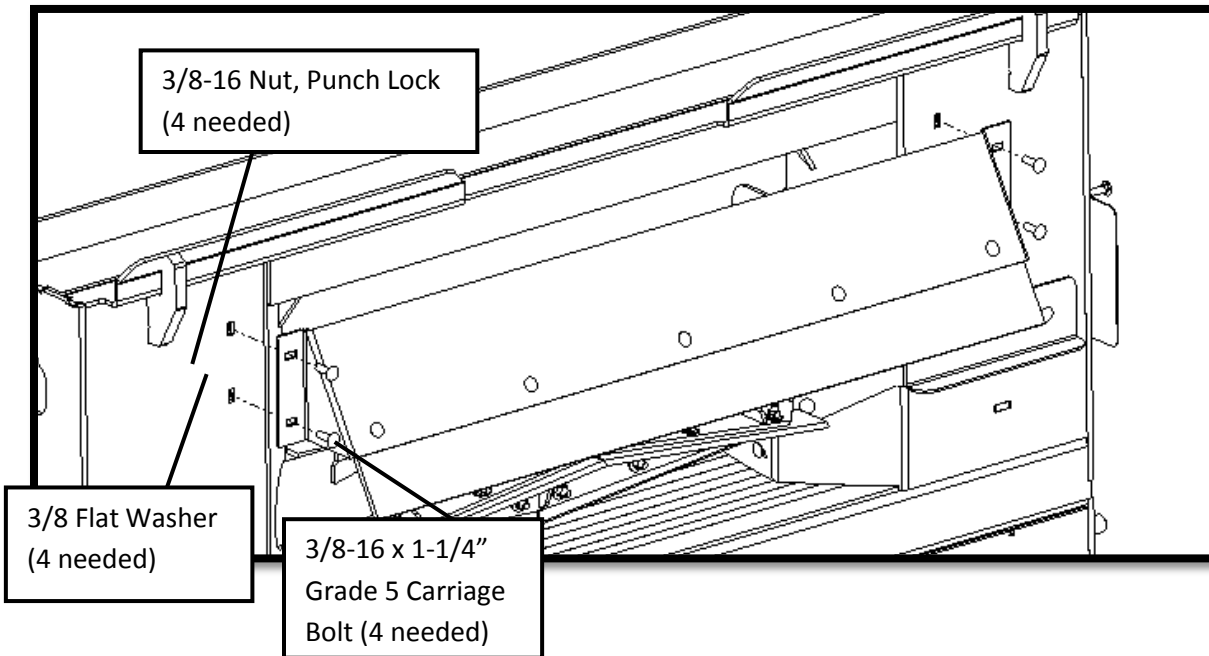

6. Install the drive transfer assembly as shown.

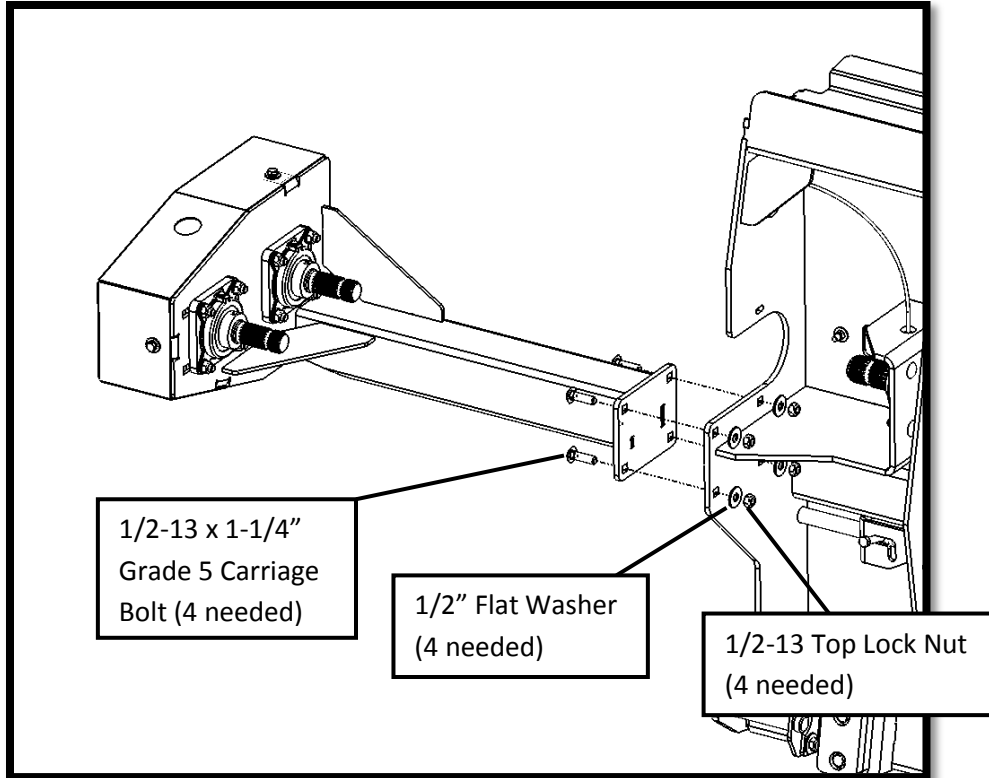

7. Install the PTO shaft as shown. The PTO shield is removed for drawing clarity, DO NOT REMOVE PTO GUARD.

